

Sofia

2 Story | 3 Bed | 2.5 Bath | 2 Car Garage | 1,829 Sq. Ft.

— SORTINO TOWNHOMES —

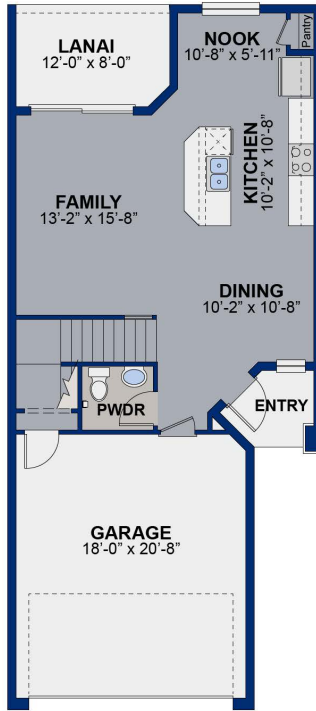

ESTANCIA
AT WIREGRASS

ESTANCIACOM | 866-985-3662
5166 SAN MARTINO DR WESLEY CHAPEL, FL 33543
TAMPAINFO@WCICOMMUNITIES.COM

Price subject to change without notice. Elevations of a home may vary and we reserve the right to substitute and/or modify design and materials, in our sole opinion and without notice. Please see your actual home purchase agreement for additional information, disclosures and disclaimers related to the home and its features. Stated dimensions and square footage are approximate and should not be used as representation of the home's precise or actual size. Any statement, verbal or written, regarding "under air" or "finished area" or any other description or modifier of the square footage size of any home is a shorthand description of the manner in which the square footage was estimated and should not be construed to indicate certainty. Garage sizes may vary from home to home and may not accommodate all vehicles. Please see your New Home Consultant and home purchase agreement for actual features designated as an Everything's Included feature, additional information, disclosures, and disclaimers relating to your home and its features. This is not an offer in states where prior registration is required. Void where prohibited by law. Visit SanctuaryCoveFL.com or see a WCI New Home Consultant for further details and important legal disclaimers. Copyright © 2018 Lennar Corporation WCI, the WCI logo, Sanctuary Cove and Sanctuary Cove logo are U.S. registered service marks or service marks of Lennar Corporation and/or its subsidiaries. CCG1518166. (03/18)

